

Архангельск (8182)63-90-72  
 Астана (7172)727-132  
 Астрахань (8512)99-46-04  
 Барнаул (3852)73-04-60  
 Белгород (4722)40-23-64  
 Брянск (4832)59-03-52  
 Владивосток (423)249-28-31  
 Волгоград (844)278-03-48  
 Вологда (8172)26-41-59  
 Воронеж (473)204-51-73  
 Екатеринбург (343)384-55-89  
 Иваново (4932)77-34-06

Ижевск (3412)26-03-58  
 Иркутск (395)279-98-46  
 Казань (843)206-01-48  
 Калининград (4012)72-03-81  
 Калуга (4842)92-23-67  
 Кемерово (3842)65-04-62  
 Киров (8332)68-02-04  
 Краснодар (861)203-40-90  
 Красноярск (391)204-63-61  
 Курск (4712)77-13-04  
 Липецк (4742)52-20-81  
 Киргизия (996)312-96-26-47

Магнитогорск (3519)55-03-13  
 Москва (495)268-04-70  
 Мурманск (8152)59-64-93  
 Набережные Челны (8552)20-53-41  
 Нижний Новгород (831)429-08-12  
 Новокузнецк (3843)20-46-81  
 Новосибирск (383)227-86-73  
 Омск (3812)21-46-40  
 Орел (4862)44-53-42  
 Оренбург (3532)37-68-04  
 Пенза (8412)22-31-16  
 Казахстан (772)734-952-31

Пермь (342)205-81-47  
 Россия (495)268-04-70  
 Ростов-на-Дону (863)308-18-15  
 Рязань (4912)46-61-64  
 Самара (846)206-03-16  
 Санкт-Петербург (812)309-46-40  
 Саратов (845)249-38-78  
 Севастополь (8692)22-31-93  
 Симферополь (3652)67-13-56  
 Смоленск (4812)29-41-54  
 Сочи (862)225-72-31  
 Ставрополь (8652)20-65-13

Сургут (3462)77-98-35  
 Тверь (4822)63-31-35  
 Томск (3822)98-41-53  
 Тула (4872)74-02-29  
 Тюмень (3452)66-21-18  
 Ульяновск (8422)24-23-59  
 Уфа (347)229-48-12  
 Хабаровск (4212)92-98-04  
 Челябинск (351)202-03-61  
 Череповец (8202)49-02-64  
 Ярославль (4852)69-52-93

<https://hoshizaki.nt-rt.ru/> || [hzo@nt-rt.ru](mailto:hzo@nt-rt.ru)

FM-150AKE-HC-SB / FM-150AKE-HCN-SB

Leading Naturally

 27.5%



NATURAL REFRIGERANTS

## Key Features

This modular cube ice maker uses Natural Refrigerant R290, which is environmentally friendly and energy efficient. It produces flake ice, which is often used for produce display of fish, fresh food and bottled beverages. In the medical field, flake ice is also used for organ transportation. Utilizing the most efficient ice making process due to the unique auger system, the water consumption is equal to the ice production.

-  Energy efficient, with savings up to 27.5% compared to HFC equivalent model.\*
- ✓ Member of the Emerald Class, Hoshizaki's range of climate friendly ice makers.
- ✓ Can produce 150kg of cube ice per 24 hours (AT 10°C, WT 10°C).
- ✓ Efficient ice making process due to Hoshizaki's unique FM auger system.
- ✓ Utilises all water brought into the machine; therefore water consumption is equal to ice production.
- ✓ Hoshizaki's flake ice prevents 'freeze-burn' when displaying fresh fish or produce.
- ✓ Auger is made of double hardened stainless steel. Combined with carbon bearings, they work optimally in a tough and wet environment. Benefits include: longer product life expectancy and reduced maintenance costs.
- ✓ Hoshizaki ice makers are micro computer controlled, controlling the ice making process to perform at its best under varying circumstances, without having to make physical adjustments.
- ✓ Quality stainless steel auger and evaporator increase the life expectancy of these components and the whole ice maker, as well as reducing costly maintenance visits.
- ✓ Easily cleanable air filter allows end-users to carry out routine cleaning schedules. Extends product life expectancy and reduces the frequency and costs of maintenance call-outs.

\*Based on Internal comparative study. Please contact your local sales branch to find out more.

## Available Models

Model	Air Cooled	Water Cooled
FM-150AKE-HC-SB	✓	
FM-150AKE-HCN-SB	✓	

## Bins

Model	Type of Bin	Max. Bin Capacity approx.
FM-150AKE-HC-SB	B-301SA / B-501SA / B-801SA	144kg / 217kg / 348kg
FM-150AKE-HCN-SB	B-301SA / B-501SA / B-801SA	144kg / 217kg / 348kg

## Production

Model	Ice Production per 24h approx.	Temperature	Water Consumption per 24h approx.
FM-150AKE-HC-SB	Approx. 150kg	AT 10°C, WT 10°C	0,15m <sup>3</sup>
	Approx. 125kg	AT 21°C, WT 15°C	0,13m <sup>3</sup>
	Approx. 105kg	AT 32°C, WT 21°C	0,11m <sup>3</sup>
FM-150AKE-HCN-SB	Approx. 140kg	AT 10°C, WT 10°C	0,14m <sup>3</sup>
	Approx. 120kg	AT 21°C, WT 15°C	0,12m <sup>3</sup>
	Approx. 100kg	AT 32°C, WT 21°C	0,10m <sup>3</sup>

FM-150AKE-HC-SB / FM-150AKE-HCN-SB

✓ CAD drawings available on our website

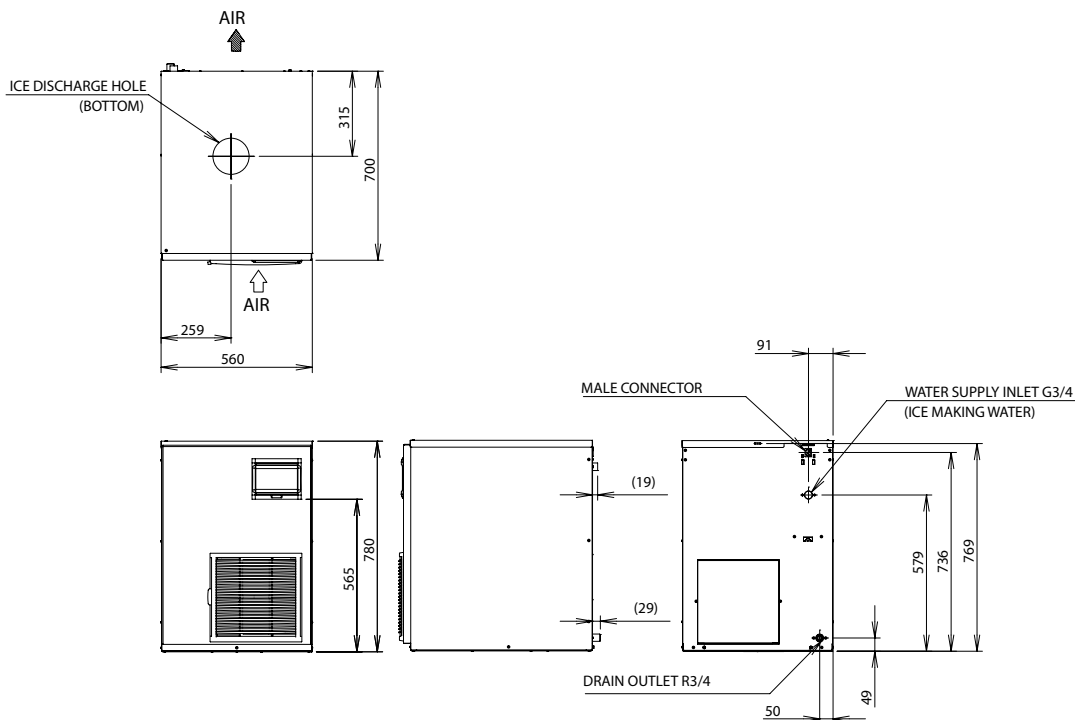

### Specifications

	FM-150AKE-HC-SB	FM-150AKE-HCN-SB
Dimensions W x D x H (mm)	560 x 700 x 780	560 x 700 x 780
AC Supply Voltage	1/220-240V 50Hz	1/220-240V 50Hz
Electric Consumption (AT.32°C, WT.21°C)	405W	405W
Heat Rejection (AT.32°C, WT.21°C)	800W	800W
Refrigerant Charge	R290 - CO <sub>2</sub> eq: 0,33kg	R290 - CO <sub>2</sub> eq: 0,33kg
Isolation	Polyurethane Foam	Polyurethane Foam
Weight Gross / Net	70kg / 63kg	70kg / 63kg

### Operation Requirements

Ambient Temperature	5 - 40°C
Water Supply Temperature	5 - 35°C
Water Supply Pressure	0,5-8bar (0,05-0.8MPa)
Voltage Range	Rated Voltage ± 6%

### Accessories

FM-150AKE-HC-SB	FM-150AKE-HCN-SB
Mounting Bracket	Mounting Bracket
Installation Kit	Installation Kit

Архангельск (8182)63-90-72  
 Астана (7172)727-132  
 Астрахань (8512)99-46-04  
 Барнаул (3852)73-04-60  
 Белгород (4722)40-23-64  
 Брянск (4832)59-03-52  
 Владивосток (423)249-28-31  
 Волгоград (844)278-03-48  
 Вологда (8172)26-41-59  
 Воронеж (473)204-51-73  
 Екатеринбург (343)384-55-89  
 Иваново (4932)77-34-06

Ижевск (3412)26-03-58  
 Иркутск (395)279-98-46  
 Казань (843)206-01-48  
 Калининград (4012)72-03-81  
 Калуга (4842)92-23-67  
 Кемерово (3842)65-04-62  
 Киров (8332)68-02-04  
 Краснодар (861)203-40-90  
 Красноярск (391)204-63-61  
 Курск (4712)77-13-04  
 Липецк (4742)52-20-81  
 Киргизия (996)312-96-26-47

Магнитогорск (3519)55-03-13  
 Москва (495)268-04-70  
 Мурманск (8152)59-64-93  
 Набережные Челны (8552)20-53-41  
 Нижний Новгород (831)429-08-12  
 Новокузнецк (3843)20-46-81  
 Новосибирск (383)227-86-73  
 Омск (3812)21-46-40  
 Орел (4862)44-53-42  
 Оренбург (3532)37-68-04  
 Пенза (8412)22-31-16  
 Казахстан (772)734-952-31

Пермь (342)205-81-47  
 Россия (495)268-04-70  
 Ростов-на-Дону (863)308-18-15  
 Рязань (4912)46-61-64  
 Самара (846)206-03-16  
 Санкт-Петербург (812)309-46-40  
 Саратов (845)249-38-78  
 Севастополь (8692)22-31-93  
 Симферополь (3652)67-13-56  
 Смоленск (4812)29-41-54  
 Сочи (862)225-72-31  
 Ставрополь (8652)20-65-13

Сургут (3462)77-98-35  
 Тверь (4822)63-31-35  
 Томск (3822)98-41-53  
 Тула (4872)74-02-29  
 Тюмень (3452)66-21-18  
 Ульяновск (8422)24-23-59  
 Уфа (347)229-48-12  
 Хабаровск (4212)92-98-04  
 Челябинск (351)202-03-61  
 Череповец (8202)49-02-64  
 Ярославль (4852)69-52-93